

WELCOME TO OUR NEW NEIGHBORS

13415 11-G4, Scott Willkomm
13615-A2, Angela Bragg & Eric Brock
13901-6B, Nancy & Doug & Zach Honig
13801-2B, Shannon Reaze
13705-1A, Virginia Davidson
13705-6A, Trisha & Jeff Cole
13415 11-S5, Rajiv Joseph
13615-2C, Monica Jackson
13515-2A, Jan & Mike Devereaux
13805-4B, Shayan Yousefzai & Jean Munn
13705-4B, Jeff Wolk

MCCA Events — Our Annual Summer Picnic...

Will be held this year! Please hold the date of August 23rd, 2021 for this highly enjoyable event. Do you have a favorite summer picnic side dish you'd like to share? If so, everyone is invited to share in the potluck side dishes. Beverages and grill items will be provided by MCCA.

Please submit your favorite summer recipe in the category of appetizer, side dish or dessert to the Receptionists in the office or by via e-mail at reception@morelandcourts.com by August 5th. Written on paper is also appreciated.

Guest Suite Reservations...

...are being taken. For holiday reservations, a lottery is held 4 months in advance due to multiple requests. The Guest Suite Thanksgiving Lottery will be held July 23rd and the Christmas lottery will be held August 25. Please refer to the policy posted on the website for any additional information.

RESIDENT SPOTLIGHT

Moreland Courts enjoys a community of outstanding community leaders and highly distinguished residents in the community. Professors Faye Gary & Arthur Heuer are included in the exclusive group of Distinguished Professors at Case Western Reserve University. Though CWRU's website appropriately states that all faculty are distinguished, the Distinguished Professor designation is rare, and universities award only those whose work is above scale and have achieved the highest levels of scholarship over their careers.

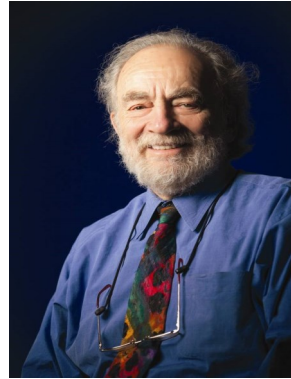

Professor Arthur Heuer came to CWRU in 1967 right after the merger of Case Institute of Technology and Western Reserve University. During his career he has supervised over 100 MS and PhD students as well as over 65 Post-Doctoral Scholars. His scholarly work includes nearly 600 articles in archival journals, several patents and editorship of several books. Dr. Heuer's work has focused on structure-property relations in "hi-tech" structural and functional ceramics, and improving corrosion resistance of stainless steels, and oxidation resistance of high temperature nickel alloys. For fun Dr. Heuer has collaborated with the Conservation Departments of the Cleveland Museum of Art and the Louvre, studying the glaze chemistry of Bernard Palissy, a well known Renaissance period ceramic master. When not researching and writing, Dr. Heuer enjoys reading, history, classical music, as well as duplicate bridge, where he has earned the rank of Silver Life Master from the American Bridge league. Dr. Heuer and his wife Joan Hulbert are parents of 4, grandparents of 12 and great grandparents of 2. They have shared indelible memories from trips with their grandchildren throughout the United States and Europe.



As faculty at the Francis Payne Bolton School of Nursing, Dr. Faye Gary, PhD holds the Medical Mutual of Ohio Kent W. Clapp Chair at the Nursing School and has a joint appointment in the department of Psychiatry at CWRU. Her 106 page CV includes over 160 publications, world wide recognition in psychiatric nursing, health care consulting for ministries of health care on six continents, and many other health care programs and services both home and abroad. She was elected an American Council of Education Fellow, served in the W.K. Kellogg Fellow Leadership Fellowship Program Group Eight, has presented research and been a keynote speaker in multiple countries. In 2019 she travelled to Singapore where she made multiple

presentations to the 2019 Congress of the International Council of Nursing, a component of the WHO. For her textbook, "Psychiatric Nursing" Dr. Gary awarded "Book of the Year" from the American Nursing Association. Dr. Gary's path to excellence required overcoming obstacles that were still prevalent in the Jim Crow South where she grew up. Her response to this challenge foreshadowed her ability to achieve at the highest levels, inspiring her dedication to continue to promote the underrepresented. As developer of the Provost Scholars program at CWRU Dr. Gary leads a program dedicated to mentoring secondary education students in East Cleveland to pursue their own educations, and has inspired many others to join that endeavor.

Do you have a suggestion for our next Resident Feature article?

Would you like to be a contributor for our next newsletter?

Please submit your article to Reception@morelandcourts.com.

THANK YOU!



July 2021

Moreland Courts News

EXHIBIT IN THE 12 GALLERY ~

Suzan Kraus & Charlotte Lees



Suzan Kraus is a contemporary multi-media collage artist. Through the intuitive manipulation of handmade and hand painted paper, she creates designs that are enlivened with earthy colors and textures. Kraus creates mixed-media works with handmade papers from around the world and accentuates them with found objects. She utilizes this technique to convey subtle sensitivities about life that would normally not be evident in a painting. As a hobby, she has also taken up Chinese brush painting. About her art Kraus has said, "Just like life, doing art is a journey of discovery. Each piece of work that I get involved in is a metaphorical symbol of where I am mentally, physically and spiritually in my process of coming to consciousness. I truly feel that because of some very auspicious star alignment, I have been awarded this grand opportunity to be an artist and teacher. It is my full time job that I take quite seriously and approach with a grateful mind and heart."



Charlotte Lees is a Cleveland-area native with a personal and deep connection to Cleveland. In high school she decided to become an artist and took classes at the Cleveland Museum of Art and the Cleveland Institute of Art. Charlotte later graduated cum laude from Bowling Green State University with a BS and went on to receive her MA from Case Western Reserve University and the Cleveland Institute of Art. She has had numerous exhibitions throughout the United States, including an exhibition entitled, On/Off the Wall in the Desert Art Collection of Palm Desert, California (2007). She has been recognized with numerous awards including the Frances E. Willard Award Alpha Phi International Outstanding Career Achievement Award (2002). One recognition that particularly stands out to Charlotte is the Ohio Arts Council Individual Artists Fellowship, which she received in 1995. Since Cleveland has been Charlotte's home for many years now, she was honored to have received the Fellowship, with which she explored ancient musical instruments. Influenced by Pre-History, African, Egyptian, Greek, and Indian cultures, she says that she finds "by studying these societies I am able to create contemporary images that have historical and cultural references. This blending of souls imparts a more meaningful context to my work"

As a sculptor she works with a variety of media that include wood, glass, and various metals. Charlotte describes herself as a "life-long learner" and continues to study at various art institutions. She is "constantly trying to expand her artistic vocabulary and looks forward to the challenges of developing new sculptural imagery."

Thank You!

To Lee Heinen who has continued to provide new and interesting exhibitions for our Gallery.

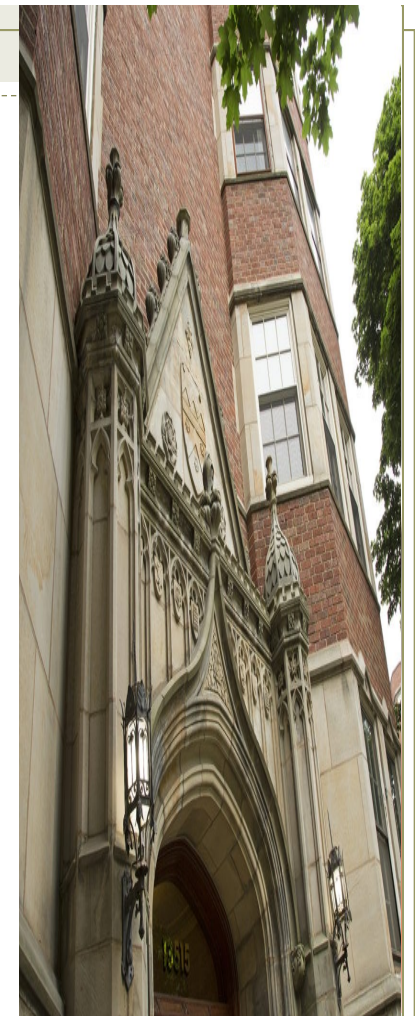

INSIDE THIS ISSUE

A Message from the Board President ...	2
Committee updates	3
Exercise Facility	3
Resident Spotlight ..	4
Welcome New Neighbors	4
MCCA Events	4
Guest Suite Reservations	4

A MESSAGE FROM THE BOARD PRESIDENT



Let me introduce myself as your new Board President. My involvement in governance includes Board Service for the past five years, Budget and Finance Committee before that and chairing the Facilities Committee as Board Vice-President last year. These experiences offered varied perspectives on the financial requirement and physical condition of our community and homes.

Cynthia and I have lived at Moreland Courts since 2007 enjoying terrific neighbors within the beautiful architectural features of this place. Arriving here at a time of fiscal stress both at Moreland Courts and nationally, we observed its steady rise in stability and well being.

I am fortunate to be following Scott Fine who provided such steady and capable leadership for the Association. As you may know, Scott led the Association these past four years, guiding us through difficult times, while also overseeing significant positive change for the Association. We're grateful for his service.

This is a good time for the Association. Our financial condition is excellent and the physical appearance of the place, indoors and out, has never looked better. Big capital improvements have just been completed or will be soon. These include the rear entrance to the East Tower and new sidewalks in front of the Courts. Other improvements on the way are the new Exercise Facility which should be opening soon, renovations to the Security Office, and a new lunchroom for the staff. These should be completed by summers end.

We are well into the transition from the height of the pandemic experience; we have weathered a challenging 15 months. That we have come through this crisis unscathed is attributable to the care taken by both residents and staff, and to our General Manager, Paul Stroud. Paul, together with the Board and with the advice of a Council of Physicians, residents all, helped chart a thoughtful and protective path through a difficult time.

The recent collapse of the residential structure in Florida has been a sober reminder of our mutual responsibility to understand, plan for and adequately finance the maintenance and repair of our infrastructure. Fortunately, we embarked on a program of professional planning and financing for Moreland Court's capital needs some years ago and have continued to give this a high priority in our annual budgeting process. Paul's recent message to residents describes in detail the tools used, including a Capital Reserve Study, to address Moreland Court's capital needs both short and long term.

Most of us residing here from the Mid-aughts remember the financial burden that residents endured to address capital repairs that had been deferred, which necessitated financing a Capital Loan totaling \$12 million dollars. This followed an emergency Special Assessment of \$3 million. We learned from that mistake: it is much better to pay forward than to play catch up with needed capital expenditures.

The work that we do here at Moreland Courts is truly a collaborative effort. It involves our Board and Committees, working alongside our General Manager Paul Stroud and staff. This is a strong team. I look forward to a year of service with them.

John Beeker,
Board President

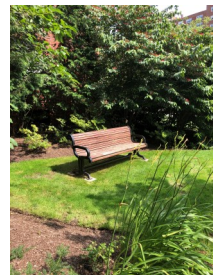
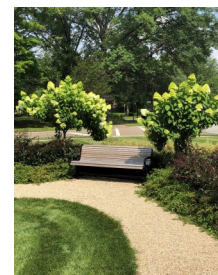

Have you seen all the new areas for outdoor seating? Tell us where'd you'd like more!

MCCA Exercise Facility

After many delays due supply chain obstructions, the preparations for the new MCCA Exercise Facility are completed, and the equipment will be delivered on July 23rd. To start there will be a weight machine, treadmill, stationary bike and elliptical machine. There will be instructional posters mounted adjacent to the machinery.

In the interest of safety and smooth operations there will be a number of forms required to use of the facility; Waiver and Release of Liability, General Health Form in the event of emergency, and a General Rules Guide. These forms will be provided upon request from the office.



.....Waiting for the delivery of our new exercise machines!

Some of the things we've done this summer....



East Tower Ramp Down



East Tower Ramp Up!



East Tower Ice Melt



New Courts Sidewalk

The new back entrance to the East Tower solved a serious access problem, while at the same time replaced the badly deteriorated retaining wall and steps. Access for those with mobility issues is an important objective and we will continue to look for opportunity to improve in that area in other places. The Courts sidewalk presents so many advantages over the old sandstone sections. It will be a safer, smoother and aesthetically improved installation that will be in place for many

....this might be the real reason for all the supply chain problems....



WHAT'S GOING ON....

COMMITTEE UPDATES

Despite the inability for public meetings, governance is very active as the following updates demonstrate.

Landmark....Continues to meet with regular work meetings. They are working on both exterior and interior projects and looking forward to new Leadership with Karen Schiavone who has agreed to chair the committee after serving as a Director on the Board for many years.

Marketing & Resident Experience....is planning for the MCCA Centennial in 2022. Plans for picnics, dinners as well as other markers to note a grand birthday for Moreland Courts. Stay tuned for more exciting news from Marketing.

Facilities....Has authorized a large schedule of capital improvements in 2021. The usual masonry repairs are being made to stone and brick work, continuing the restoration of laundry rooms, updating the Security Office, creating an employee break room, and upgrading the Association Board Room

Budget & Finance...will be meeting soon with management to begin planning for the 2022 Budget.

Rules.... has generated new policies for the new Exercise Facility.